

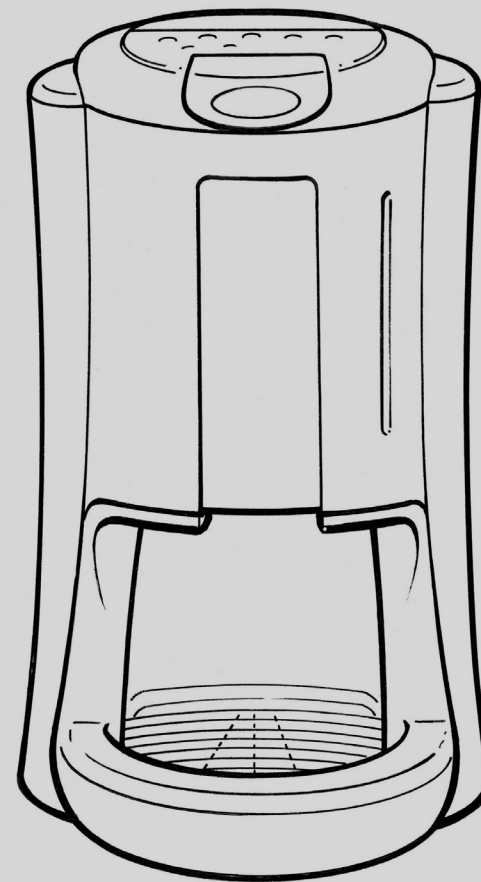

FLAVIA® Creation 200™/MC

User Guide Guide

Utilisateur USA / CANADA



DAILY CARE

EMPTYING THE DRIP TRAY

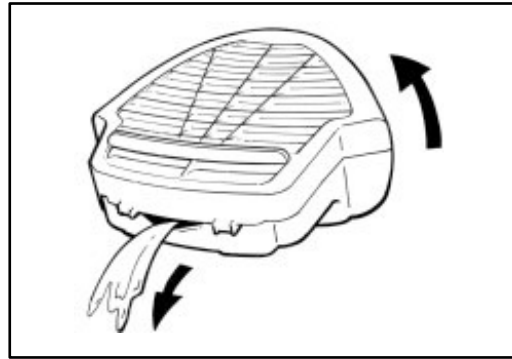

Step 1
Lift out the drip tray and drain liquid contents

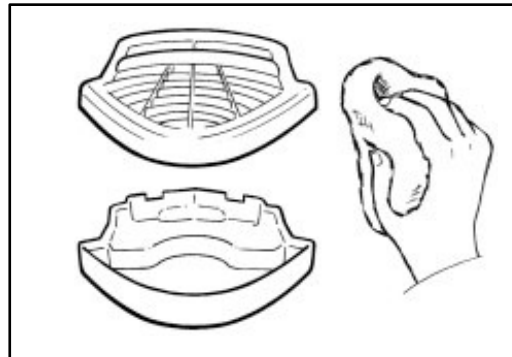

Step 2
Separate the drip tray, liner and cup stand and clean them in warm soapy water.
Wipe the surrounding area of the Brewer clean with a damp cloth.

Step 3
Reassemble and replace drip tray.

Note

Your Brewer does not tell you when the drip tray is full, so make sure that you check it regularly.

REFILLING WITH WATER (APPLIANCES SET FOR 'MANUAL FILL' ONLY)

The Brewer will illuminate the 'ADD WATER' symbol  when it requires refilling.



Step 1
Lift the 'Filler lid'.

Step 2
Carefully fill the reservoir with drinking water (no higher than the 'MAX' level)

During operation the water level may be monitored through the sight tube (visible from the front of the Brewer).

Volume of water required to fill to 'MAX' level from 'LOW' level indication

With Filter Fitted	Without Filter Fitted	= 90 fl oz (2.7L)
		= 100 fl oz (3.0L)

WEEKLY CARE

GENERAL CLEANING

Wipe the outside of the Brewer with a damp cloth.

Remove the door liner by pulling downwards when the handle is in the 'down' position. Clean with a damp cloth and replace. Remove the drip tray pull the handle up and clean the area indicated on the diagram.

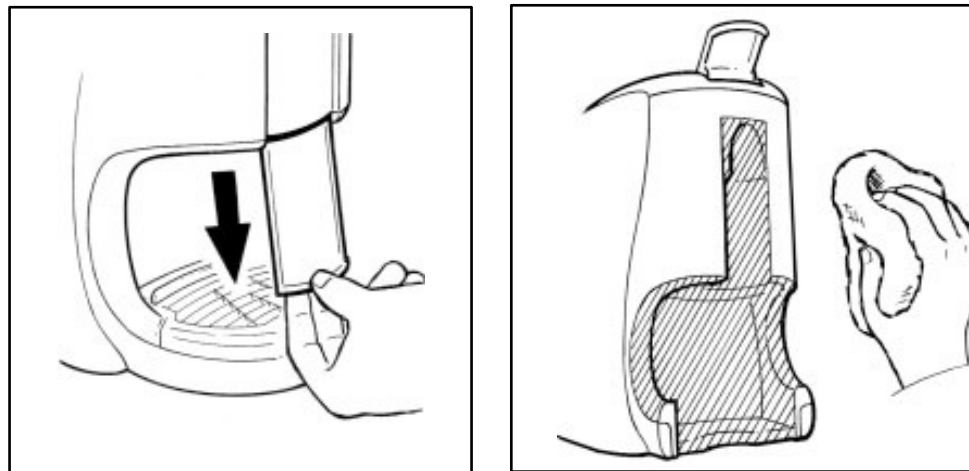

Do not clean with brushes or scouring agents as this may damage the surface of your Brewer.
Do not wash with excessive amounts of water, it could get into the Brewer causing a malfunction. Do not use cleaning agents as they may leave a residue on the Brewer.
Do not apply any products that contain benzene, they may damage the surface of your Brewer. Do not use strong detergents.
Take care not to get soapy water into the water tank as this will affect drink taste.

PERIODIC MAINTENANCE

DRAINING THE COLD WATER RESERVOIR

On occasion it may be necessary to drain the Cold Water Reservoir. For example: when setting the Brewer for 'plumbed' operation, when transporting (or storing) the Brewer; or when refreshing the water supply.

MAKE SURE YOUR BREWER IS SWITCHED OFF.

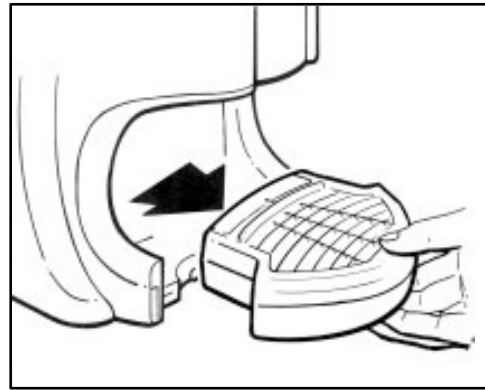

Step 1
Remove the drip tray.

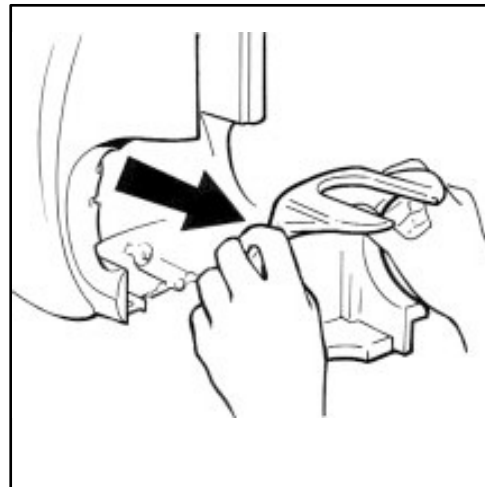

Step 2
Remove the cup surround liner by holding the two outer edges and pulling forward.



Step 3
Pull the machine forward to the edge of the worktop and place a large jug underneath.

Step 4
Remove the rubber seal and drain the water. Note that the water may flow fast, depending on how much water is held in the reservoir.

WATER FILTER REPLACEMENT

Your Brewer is fitted with a Water Filter to ensure the water used in brewing your beverages is of optimal quality. To maintain the quality of beverages brewed, while protecting and extending the life of your Brewer, you will need to replace this filter periodically. The frequency of replacement depends on the number of drinks brewed.

The recommended replacement frequency is approximately every 800 beverages or three months whichever comes first.

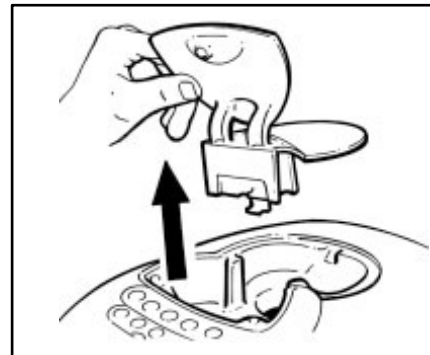

Step 1

Remove the water filter covers to access the water filter. Remove the filter by turning it counter-clockwise. Discard the used filter

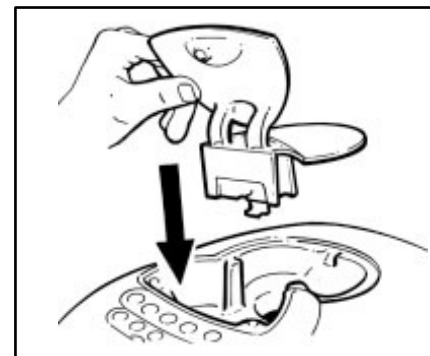
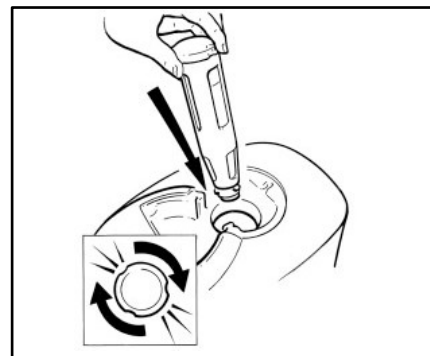

Step 2

Insert the replacement filter and rotate it clockwise to engage with the bayonet fitting inside the cold water reservoir. Replace the water filter covers.

Note

At the top of the water filter cartridge there is a rotating 'date cap' which may be set to serve as a reminder of the anticipated replacement date

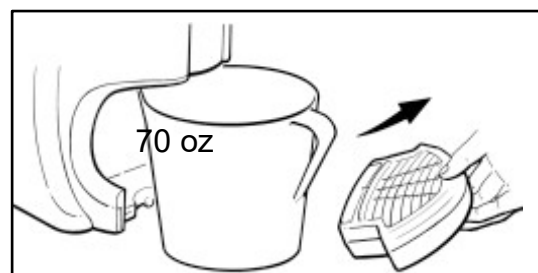

Step 3

The new filter will need to be 'primed'. Remove the drip tray from the Brewer and place a large container in the dispense area.

Step 4

Turn the Brewer off. Press and hold the 'HOT WATER' and 'LARGE CUP' buttons.

Turn the Brewer back on whilst continuing to hold the two buttons whilst the Brewer powers up. Then release the two buttons, the 'CALL OPERATOR' symbol and 'HOT WATER' button will now illuminate.

Now Press the 'HOT WATER' button to begin the FLUSH cycle.

The Brewer will start to 'pump', and water will be dispensed into the container. The Brewer will automatically stop pumping after about 2 minutes when the flush cycle is finished. It will pump approximately 60 fl oz (1.7L) of water.

The water jet may be seen to 'splutter' for a short while, this is normal.

The water flow can be stopped and re-started by pushing the 'HOT WATER' button, if required. The system is now flushed and will begin to heat the water. When complete the 'Drinks Selection' lights will illuminate.

Your Brewer is now ready to continue making drinks.